

Diane Smith
Hardee County
Supervisor of Elections

October 29, 2018

Mr. Terry Atchley
317 S. 9th Ave.
Wauchula, FL 33873

Dear Mr. Atchley,

This Office has been informed that you may not reside at the physical address that is indicated on your Voter's Registration Application (317 S. 9th Ave.; Wauchula, FL). Please complete the enclosed Voter's Registration Application and return it to this Office within 30 days, along with any proofs of your residency at 317 S. 9th Ave.; Wauchula, FL. Failure to do so will result in the removal of your name from the voter registration roll.

Sincerely,



Diane Smith, Hardee County Supervisor of Elections

Enclosure

CC: Gary Holland, Asst. General Counsel, Florida Dept. of State

Every Vote Counts!

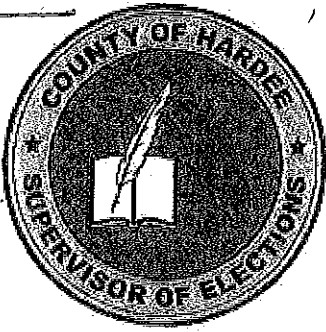
311 N. 6th Ave. Wauchula, FL 33873
Phone : (863) 773-6061 Fax : (863) 773-6813
E-mail: Info@HardeeCountyElections.com
Website: www.HardeeCountyElections.com



Diane Smith
Hardee County
Supervisor of Elections

October 29, 2018

Mr. Gary Holland,
Assistant General Counsel
Florida Department of State
R. A. Gray Building
500 South Bronough St.
Tallahassee, FL 32399-0250

Reference: Legal residence of Terry Atchley, City of Wauchula City Manager

Dear Mr. Holland,

Because of the complaint that was filed against Terry Atchley, City of Wauchula's City Manager, on today's date a letter was sent to Mr. Terry Atchley in an effort to determine his legal residence address (copy enclosed). It was sent by certified mail. I enclosed a Voter's Registration Application with the letter. Mr. Atchley was given 30 days to respond.

Thank you for your assistance in this matter.

Respectfully,

Diane Smith, Hardee County Supervisor of Elections

Enclosure

Every Vote Counts!

311 N. 6th Ave. Wauchula, FL 33873
Phone : (863) 773-6061 Fax : (863) 773-6813
E-mail: Info@HardeeCountyElections.com
Website: www.HardeeCountyElections.com



Florida Voter Registration Application
Part 1 - Instructions (DS-DE 39, R1S-2.040, F.A.C.) (eff. 10/2013)

Information en español: Sirvase llamar a la oficina del supervisor de elecciones de su condado si le interesa obtener este formulario en español.

To Register in Florida, you must be:

- a U.S. citizen,
- a Florida resident,
- at least 18 years old (you may pre-register at 16 or 17, but cannot vote until you are 18).

If you have been convicted of a felony, or if a court has found you to be mentally incapacitated as to your right to vote, you cannot register until your right to vote is restored.

If you do not meet any **ONE** of these requirements, you are not eligible to register.

Questions?

Contact the Supervisor of Elections in your county:
dos.myflorida.com/elections/contacts/supervisor-of-elections
Visit the Florida Division of Elections' website at:
dos.myflorida.com/elections

Where to Register: You can register to vote by completing this application and delivering it in person or by mail to any supervisor of elections' office, office that issues driver's licenses, or voter registration agency (public assistance office, center for independent living, office serving persons with disabilities, public library, or armed forces recruitment office) or the Division of Elections. Mailing addresses are on page 2 of this form.

Deadline to Register: The deadline to register to vote is 29 days before any election. You can update your registration record at any time, but for a Primary Election, party changes must be completed 29 days before that election. You will be contacted if your new application is incomplete, denied or a duplicate of an existing registration. Your Voter Information Card will be mailed to you once you are registered.

Identification (ID) Requirements: New applicants must provide a current and valid Florida driver's license number (FL DL#) or Florida identification card number (FL ID#). If you do not have a FL DL# or FL ID#, then you must provide the last four digits of your Social Security number (SSN). If you do not have any of these numbers, check "None." If you leave the field and box blank, your new registration may be denied. See section 97.053(6), Fla.Stat.

Special ID requirements: If you are registering by mail, have never voted in Florida, and have never been issued one of the ID numbers above, include one of the following with your application, or at a later time before you vote: 1) A copy of an ID that shows your name and photo (acceptable IDs—U.S. Passport, debit or credit card, military ID, student ID, retirement center ID, neighborhood association ID, or public assistance ID); or 2) A copy of an ID that shows your name and current residence address (acceptable documents—utility bill, bank statement, government check, paycheck, or other government document).

The special ID is not required if you are 65 or older, have a temporary or permanent physical disability, are a member of the active uniformed services or merchant marine who is absent from the county for active duty, or a spouse or dependent thereof, or are currently living outside the U.S. but otherwise eligible to vote in Florida.

Political Party Affiliation: Florida is a closed primary election state. In primary elections, registered voters can only vote for their registered party's candidates in a partisan race on the ballot. In a primary election, all registered voters, regardless of party affiliation, can vote on any issue, nonpartisan race, and race where a candidate faces no opposition in the General Election. If you do not indicate your party affiliation, you will be registered with no party affiliation. For a list of political parties, visit the Division of Elections' website at: dos.myflorida.com/elections

Race/Ethnicity: It is optional to list your race or ethnicity.

Boxes: Please check boxes () where applicable.

Numbered rows 1 through 7 and 12 must be completed for a new registration.



Florida Voter Registration Application
Part 2 - Form (DS-DE #39, R1S-2.040, F.A.C.) (eff. 10/2013)

The downloadable/printable online form is available at:
dos.myflorida.com/elections/for-voters/voter-registration

This is: New Registration Record Update/Change (e.g., Address, Party Affiliation, Name, Signature) Request to Replace Voter Information Card

1	Are you a citizen of the United States of America? <input checked="" type="checkbox"/> YES <input type="checkbox"/> NO			OFFICIAL USE ONLY RECEIVED NOV 26 2018 Initial: <u>ds</u> FVRS No.:				
2	<input checked="" type="checkbox"/> I affirm that I am not a convicted felon, or if I am, my right to vote has been restored.							
3	<input checked="" type="checkbox"/> I affirm that I have not been adjudicated mentally incapacitated with respect to voting or, if I have, my right to vote has been restored.							
4	Date of Birth (MM-DD-YYYY)	12	-			18	-	19
5	Florida Driver License (FL DL) or Florida identification (FL ID) Card Number			If no FL DL or FL ID, then provide	Last 4 digits of Social Security Number	<input type="checkbox"/> I have NONE of these numbers.		
6	Last Name	First Name	Middle Name	Name Suffix (Jr., Sr., I, II, etc.):				
	Atchley	Terry	Wayne					
7	Address Where You Live (legal residence-no P.O. Box)	Apt/Lot/Unit	City	County	Zip Code			
	317 S. 9th Avenue		Wauchula	Hardee	33873			
8	Mailing Address (if different from above address)	Apt/Lot/Unit	City	State or Country	Zip Code			
9	Address Where You Were Last Registered to Vote	Apt/Lot/Unit	City	State	Zip Code			
	317 S. 9th Avenue		Wauchula	Hardee	33873			
10	Former Name (if name is changed)	Gender <input checked="" type="checkbox"/> M <input type="checkbox"/> F	State or Country of Birth	Telephone No. (optional)				
			Fla.	(863) 781-9402				
11	<input type="checkbox"/> Email me SAMPLE BALLOTS if option is available in my county. (See Public Record Notice above) My email address is:							

Party Affiliation (Check only one. If left blank, you will be registered without party affiliation) <input type="checkbox"/> Florida Democratic Party <input checked="" type="checkbox"/> Republican Party of Florida <input type="checkbox"/> No party affiliation <input type="checkbox"/> Minor party (print party name):	Race/Ethnicity (Check only one) <input type="checkbox"/> American Indian/Alaskan Native <input type="checkbox"/> Asian/Pacific Islander <input type="checkbox"/> Black, not of Hispanic Origin <input type="checkbox"/> Hispanic <input checked="" type="checkbox"/> White, not of Hispanic Origin <input type="checkbox"/> Multi-racial <input type="checkbox"/> Other:	(Check only one if applicable) <input type="checkbox"/> I am an active duty Uniformed Services or Merchant Marine member <input type="checkbox"/> I am a spouse or a dependent of an active duty uniformed services or merchant marine member <input type="checkbox"/> I am a U.S. citizen residing outside the U.S.	<input type="checkbox"/> I will need assistance with voting. <input type="checkbox"/> I am interested in becoming a poll worker.
--	--	--	---

12	Oath: I do solemnly swear (or affirm) that I will protect and defend the Constitution of the United States and the Constitution of the State of Florida, that I am qualified to register as an elector under the Constitution and laws of the State of Florida, and that all information provided in this application is true.	SIGN/MARK HERE 	Date 11/26/2018
----	--	---------------------------	--------------------

Terry W. Atchley
City Manager
126 South 7th Avenue
Wauchula, FL 33873



Phone: (863)773-3131
(863)773-3535
Fax: (863)773-0773
tatchley@cityofwauchula.com

The Honorable Diane Smith
Supervisor of Elections, Hardee County
311 N. 6th Avenue
Wauchula, Fl. 33873

November 26, 2018

RECEIVED

NOV 26 2018

Initial: ds

Dear Supervisor Smith,

This letter is in response to your request dated October 29, 2018 asking that I complete a new Voter's Registration application and return it you your office, along with any proof of my residency at 317 S. 9th. Avenue, Wauchula Fl. 33873

It has been and continues to be my intention that the home located at 317 S. 9th. Avenue, Wauchula is my legal residence as evidenced by the attached data provided.

Attachments;

- A – Newly Completed Florida Voter Registration application.
- B – Current Florida Driver License.
- C – Current Voter Registration Card.
- D - Current Payroll Stub.
- E – Current utility bill.
- F – Current Property Appraiser Card showing Homestead Exemption
- G – Current vehicle registrations.

I hope this addresses any questions you may have.

Respectfully,

A handwritten signature in blue ink that reads "Terry W. Atchley". The signature is written in a cursive style.



Diane Smith
*Hardee County
Supervisor of Elections*

October 29, 2018

*Mr. Terry Atchley
317 S. 9th Ave.
Wauchula, FL 33873*

Dear Mr. Atchley,

This Office has been informed that you may not reside at the physical address that is indicated on your Voter's Registration Application (317 S. 9th Ave.; Wauchula, FL). Please complete the enclosed Voter's Registration Application and return it to this Office within 30 days, along with any proofs of your residency at 317 S. 9th Ave.; Wauchula, FL. Failure to do so will result in the removal of your name from the voter registration roll.

Sincerely,

Diane Smith, Hardee County Supervisor of Elections

Enclosure

CC: Gary Holland, Asst. General Counsel, Florida Dept. of State

Every Vote Counts!

311 N. 6th Ave. Wauchula, FL 33873
Phone : (863) 773-6061 Fax : (863) 773-6813
E-mail: Info@HardeeCountyElections.com
Website: www.HardeeCountyElections.com

RECEIVED

NOV 26 2018

Initial: LS

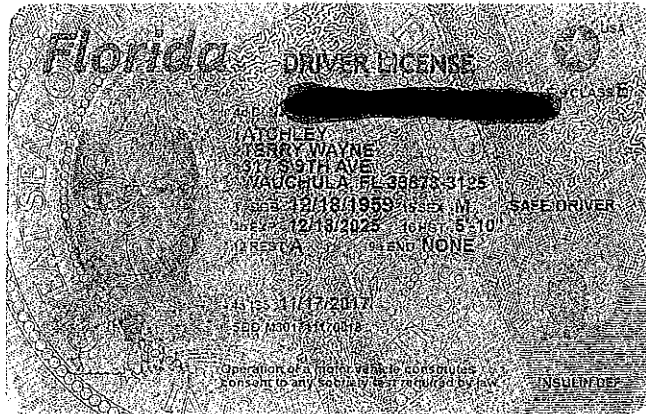

HARDEE COUNTY - VOTER INFORMATION CARD
(TARJETA INFORMACION DE VOTANTE)

Terry Wayne Atchley
317 S 9th Ave
Wauchula FL 33873

REGIS NO. NO. DE REGIS	REGIS. DATE FECHA DE REGIS	BIRTH DATE FECHA DE NACIMIENTO	RACE RAZA	SEX SEXTO	PARTY PARTIDO
104321593	2/14/03	12/18/59	5	M	Rep

JEFF USSERY
SUPERVISOR OF ELECTIONS
311 N. 6TH AVE., WAUCHULA, FLORIDA 33873

DO NOT USE AS IDENTIFICATION AT THE POLLS

PCT. NO. 06

YOUR DISTRICTS ARE:
SUS DISTRITOS SON:

CONGRESS CONGRESO	FL SENATE SENADO DE FL	FL HOUSE CASA DE FL
17	26	56

COUNTY CONDADO	SCHOOL ESCUELA	CITY CIUDAD	FIRE DIST. DIST. DE FUEGO
3	3	Wau	

POLLING LOCATION:

COUNTY COMMISSION CHAMBERS
412 W ORANGE ST, WAUCHULA FLA. 33873

=====E A R N I N G S=====			=====D E D U C T I O N S=====			=====T A X E S=====			=====R E C A P=====		
HOURS	CURRENT	YTD	DEDUCTION	CURRENT	YTD	CURRENT	YTD	CURRENT	YTD	CURRENT	YTD
GROSS	3,966.40	85,421.60	PTAX RET	396.64	8,542.16	FEDERAL	347.52	7,551.40	GROSS	3,966.40	85,421.60
EXEC PAY	80.00	3,966.40	P AFLAC 1	66.35	729.85	MEDICARE	47.38	1,023.60	TAXES	394.90	8,575.00
VLEAVE	0.00	773.92	P AFLAC 2	0.00	663.50				DEDUCT	1,004.30	19,879.29
HOLIDAY	0.00	1,160.88	UNITED WA	10.00	220.00				NET	2,567.20	56,967.31
			Christmas	250.00	4,450.00						
			FL BLUE E	35.92	692.22						
			HSA EE CO	200.00	4,200.00						
			AMERICAN	20.00	280.00						
			A FCL 1	25.39	76.17						
			A FCL 2	0.00	25.39						
						=====LEAVE AVAILABLE=====					
						VACATION	136.00		=====LTD PENSION=====		
						SICK	588.00		PRE-TAX		66,431.38
						PLEAVE	8.00				
									=====DIRECT DEPOSIT=====		
									CHECKING263179804		2,567.20

RECEIVED

NOV 26 2018

Initial:

ds

CITY OF WAUCHULA - 126 South 7th Avenue - Wauchula, FL 33873 - (863) 773-3131



CITY OF WAUCHULA
126 South 7th Avenue
Wauchula, FL 33873
(863) 773-3131

DEPOSIT NOTICE

DATE	AMOUNT
11/02/2018	\$ * 2 , 5 6 7 . 2 0

PAID
TO THE
ACCOUNTS
OF

TERRY W ATCHLEY

CITY OF WAUCHULA
126 South 7th Avenue
Wauchula, FL 33873
(863) 773-3131

TERRY W ATCHLEY
317 S 9TH AVE
WAUCHULA FL 33873



CITY OF WAUCHULA
 126 S. 7th Avenue
 Wauchula, FL 33873-2802
 (863) 773-3131



RECEIVED

NOV 26 2018

Initial: ds

TERRY ATCHLEY
 317 S 9TH AVE
 WAUCHULA FL 33873

Account Number	08-12507-01	Amount Due	\$245.95
Due Date	11/09/2018	After Due Date Pay	PAID BY DRAFT
Service Address			
317 S 9TH AVE			

There will be a charge on all returned checks.
 Please return this portion with your payment.
 When paying in person, please bring both portions of this bill.

CITY OF WAUCHULA
 126 S. 7th Avenue
 Wauchula, FL 33873-2802

Please return this portion with your payment. When paying in person please bring both portions of this bill.

CUSTOMER ACCOUNT INFORMATION - RETAIN FOR YOUR RECORDS

Name		Service Address			Account Number	
TERRY ATCHLEY		317 S 9TH AVE			08-12507-01	
Status	Service Dates		Number of Days	Bill Date	Penalty Date	Due Date
	From	To				
ACTIVE	09/12/2018	10/09/2018	27	10/17/2018	11/09/2018	11/09/2018

CURRENT		PREVIOUS	
DATE	READING	DATE	READING
10/09/2018	2160	09/12/2018	753
10/09/2018	1552750	09/12/2018	1548920

PREVIOUS BALANCE		288.27
PAYMENTS		238.16-
ADJUSTMENTS		50.11-
CURRENT BALANCE		\$0.00
USAGE		
1407	ELECTRIC	125.88
	FUEL ADJ @ 0.0110	15.48
3830	WATER	13.21
3830	SEWER	46.06
	GARBAGE	10.34
	GARBAGE	28.58
	CITY TAX	10.95
	SALES TAX	3.62
	ACTUAL BILL	254.12
	AMP ADJUSTMENT	8.17-
	RESERVE	104.47-

CURRENT BILL \$245.95

AMOUNT DUE \$245.95

* DO NOT PAY - PAID BY DRAFT*

HCPA Hardee County Property Appraiser

RECEIVED

Proposed 3rd Homestead Exemption

Proposed Hx

NOV 26 2018

Initial: 

Find out if you will receive any exemption benefit from the proposed 3rd Homestead Exemption

Parcel Summary

Parcel ID 09-34-25-0290-00002-001A
 Location Address 317 9TH AVE S
 WAUCHULA 33873
 Brief .24 AC COMM AT NE COR BLK 2 W 120 FT TO POB S 97.53 FT W 129.22 FT TO A PT ONE/LYR/W LINE OF NINTH AVE NE/LY 100 FT E 106.41 FT TO
 Tax Description* POB KAYTON & MADDOX ADDITION OR256P770 258P321 449P530 535P638 656P215 709P1209 200925009003/DC-RHJ/9004-AFF/9005-WD/9006-AFF
 *The Description above is not to be used on legal documents.
 Property Use Code SINGLE FAM (000100)
 Sec/Twp/Rng 9-34-25
 Tax District CITY OF WAUCHULA (District 902)
 Millage Rate 21.4897
 Acreage 0.240
 Homestead Y

[View Map](#)

Owner Information

Primary Owner
 Atchley Terry W & Filomena
 317 S 9th Ave
 Wauchula, FL 33873

Map



Valuation

	2018 Certified Values	2017 Certified Values	2016 Certified Values
Building Value	\$80,295	\$65,822	\$62,358
Extra Features Value	\$421	\$421	\$421
Land Value	\$6,291	\$6,291	\$6,291
Land Agricultural Value	\$0	\$0	\$0
Agricultural (Market) Value	\$0	\$0	\$0
Just (Market) Value	\$87,007	\$72,534	\$69,070
Assessed Value	\$64,901	\$63,566	\$62,259
Exempt Value	\$39,901	\$38,566	\$37,259
Taxable Value	\$25,000	\$25,000	\$25,000
Maximum Save Our Homes Portability	\$22,106	\$8,968	\$6,811

Land Information

Code	Land Use	Number of Units	Unit Type	Frontage	Depth
000100	SFR	10,486.00	SF	98	107

Residential Buildings

Building 1
 Type SINGLE FAM
 Total Area 1,653
 Heated Area 1,137
 Exterior Walls COMMON BRK;
 Roof Cover COMP SHNGL;
 Interior Walls DRYWALL;
 Frame Type WOOD FRAME
 Floor Cover CARPET; TILE
 Heat AIR DUCTED
 Air Conditioning CENTRAL
 Bathrooms 2
 Bedrooms 2
 Stories 1
 Actual Year Built 1971
 Effective Year Built 1971

Extra Features

Code	Description	Number of Items	Length x Width x Height	Units	Unit Type	Effective Year Built
D/W03	DRIVEWAY	1	38 x 10 x 0	380	SF	1982
PLK01	PLANK FEN	1	0 x 0 x 6	98	LF	1984
TED03	UTL SHED	1	6 x 8 x 0	48	SF	1996

Sales

Multi Parcel	Sale Date	Sale Price	Instrument	Book	Page	Instrument Number	Qualification	Reason	Vacant/Improved	Grantor	Grantee
N	12/23/2009	\$105,000	WD	0	0	200925009005	Qualified (Q)	01 - DEED EXAMINATION	Improved	RIDINGS RUTH P AND PARKER JOHN L	ATCHLEY TERRY W & FILOMENA MOLINARO H&W
N	08/22/2006	\$100	FS	709	1209		Unqualified (U)	01 - DEED EXAMINATION	Improved	PARKER GAYLE P & JOHN L AND RUTH P RIDINGS	JAUDON ROSEBUD HOWZE (LIFE ESTATE)
N	12/17/2003	\$100	FS	656	215		Unqualified (U)	01 - DEED EXAMINATION	Improved	PARKER GAYLE P & RUTH P RIDINGS	JAUDON ROSEBUD HOWZE (LIFE ESTATE)
N	09/15/1997	\$100	WD	535	638		Unqualified (U)	03 - PHYSICAL PROP CHGD AFTER SALE	Improved	JAUDON ROSEBUD H	PARKER GAYLE P & RIDINGS RUTH P
N	07/01/1993	\$0	07	449	530		Unqualified (U)		Improved		JAUDON ROSEBUD H
N	05/01/1971	\$2,500	WD	113	33		Qualified (Q)		Vacant		

Sketches

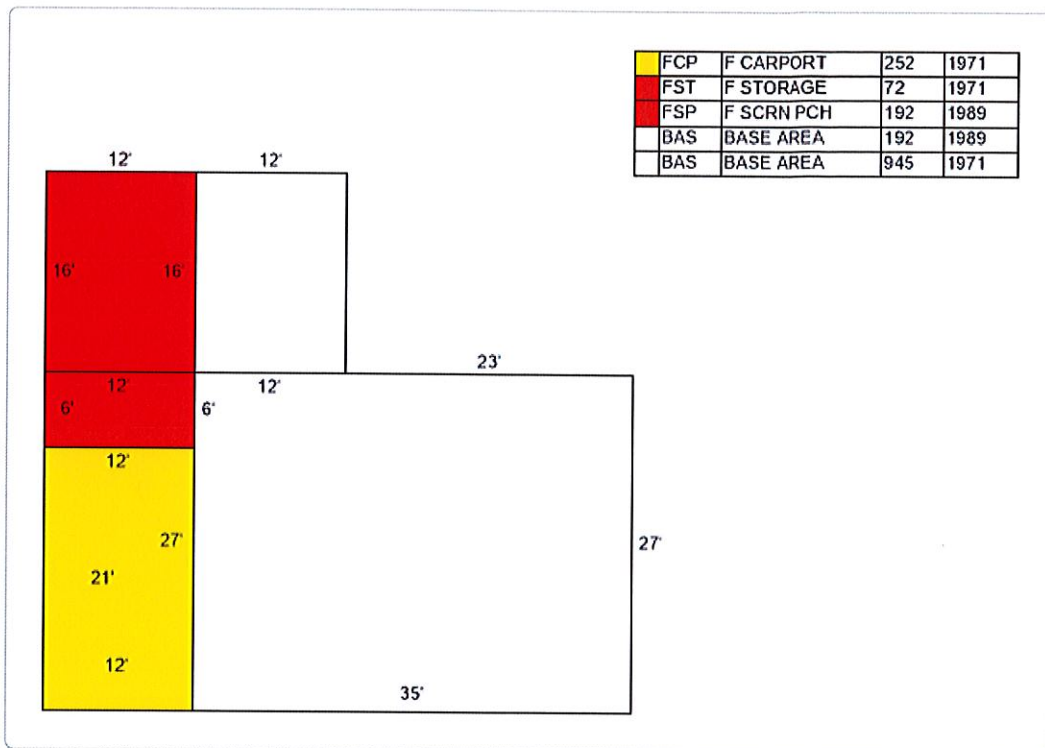

No data available for the following modules: Commercial Buildings.

The Hardee County Property Appraiser's Office makes every effort to produce the most accurate information possible. No warranties, expressed or implied, are provided for the data herein, its use or interpretation. Just (Market) Value is established by the Property Appraiser for ad valorem tax purposes. Working values are subject to change.

Last Data Upload: 10/30/2018 10:16:35 PM



RECEIVED

NOV 26 2018

Initial: *[Signature]*

Hardee County Property Appraiser Property Record Card 09-34-25-0290-00002-001A

The Hardee County Property Appraiser's Office makes every effort to produce the most accurate information possible. No warranties, expressed or implied, are provided for the data herein, its use or interpretation. The assessment information is from the working taxroll and is subject to change

.24 AC COMM AT NE COR BLK 2 ATCHLEY TERRY W & FILOMENA 09-34-25-0290-00002-001A 2018 R
W 120 FT TO POB S 97.53 FT 317 S 9TH AVE CARD 001 of 001
W 129.22 FT TO A PT ON E/LY WAUCHULA, FL 33873 PRINTED 8/12/2018 3:00 BY
R/W LINE OF NINTH AVE NE/LY APPR 6/21/2018 EG

Table with columns: BUSE, MOD, EXW, RSTR, RCVR, INTW, FLOR, HTPP, A/C, QUAL, FNND, SIZE, CEIL, ARCH, FRME, KTCH, WNDO, CLAS, OCC, COND, SUB, BAS71, BAS89, FSP89, FST71, FCP71. Includes details for single family home with various features and values.

Table with columns: AE BN, CODE, D/W, PLK, TED, LEN, WID, HGHT, QTY, YR, ADJ, PRICE, UNITS, UT, PR, SPDC, %GOOD, XFBOB, VALUE. Includes details for driveway, plank fence, and utility shed.

Table with columns: LAND, DESC, ZONE, TOPO, ROAD, DENS, COND, FRONT, DEPTH, FIELD CK, ADJUSTMENTS, UNITS, UT, PRICE, ADJ, UT, PR, LAND VALUE. Includes details for single family residential property.

B001 - 19TR FLDCK NO CHANGE TO BLDG. (EG)

FLORIDA VEHICLE REGISTRATION

CO/AGY 30 / 1 T# 1056643976
B# 511473

PLATE **Y77UHV** DECAL **16218493** Expires **Midnight Wed 12/18/2019**

YR/MK	2007/FORD	BODY	4D	COLOR	TAN	Reg. Tax	33.10	Class Code	1
VIN	3FAHP08107R215227			TITLE	98051773	Init. Reg.		Tax Months	12
Plate Type	RGR	NET WT	3234			County Fee	3.00	Back Tax Mos	
DL/FEID	[REDACTED]					Mail Fee		Credit Class	
Date Issued	11/14/2018	Plate Issued	12/16/2016			Sales Tax		Credit Months	
						Voluntary Fees			
						Grand Total	36.10		

TERRY WAYNE ATCHLEY
317 S 9TH AVE
WAUCHULA, FL 33873-3125

RECEIVED

NOV 26 2018

Initial: *(Signature)*

IMPORTANT INFORMATION

1. The Florida license plate must remain with the registrant upon sale of vehicle.
2. The registration must be delivered to a Tax Collector or Tag Agent for transfer to a replacement vehicle.
3. Your registration must be updated to your new address within 30 days of moving.
4. Registration renewals are the responsibility of the registrant and shall occur during the 30-day period prior to the expiration date shown on this registration. Renewal notices are provided as a courtesy and are not required for renewal purposes.
5. I understand that my driver license and registrations will be suspended immediately if the insurer denies the insurance information submitted for this registration.

RGR - FLORIDA REGULAR

FLORIDA VEHICLE REGISTRATION

CO/AGY 30 / 1 T# 1056644109
B# 511473

PLATE **412AHL** DECAL **16218551** Expires **Midnight Wed 12/18/2019**

YR/MK	2018/DODG	BODY	4D	COLOR	RED	Reg. Tax	68.10	Class Code	1
VIN	2C3CDXHG5JH163787			TITLE	130901197	Init. Reg.		Tax Months	12
Plate Type	EDR	NET WT	3927			County Fee	3.00	Back Tax Mos	
DL/FEID	[REDACTED]					Mail Fee		Credit Class	
Date Issued	11/14/2018	Plate Issued	12/18/2015			Sales Tax		Credit Months	
						Voluntary Fees			
						Grand Total	71.10		

TERRY WAYNE ATCHLEY
317 S 9TH AVE
WAUCHULA, FL 33873-3125

IMPORTANT INFORMATION

1. The Florida license plate must remain with the registrant upon sale of vehicle.
2. The registration must be delivered to a Tax Collector or Tag Agent for transfer to a replacement vehicle.
3. Your registration must be updated to your new address within 30 days of moving.
4. Registration renewals are the responsibility of the registrant and shall occur during the 30-day period prior to the expiration date shown on this registration. Renewal notices are provided as a courtesy and are not required for renewal purposes.
5. I understand that my driver license and registrations will be suspended immediately if the insurer denies the insurance information submitted for this registration.

EDR - SUPPORT EDUCATION